



Index - Rørkoblinger

Reparationskoblinger, NT 10 / Repair pipe coupling, NT 10	Side	116
Rørkoblinger, NT 10 / Pipe coupling NP 10	Side	112
Rørkoblinger, trækfaste, NT 16 / Pipe coupling, NT 16.....	Side	114

Rørkobling N200

Rørkobling, NT 10, type II, EPDM pakning, TEEKAY AXIFLEX

Pipe coupling NT 10, type II, EPDM seal, TEEKAY AXIFLEX

Dim	D mm	H mm	B mm	Kg/ stk/pc	EN 1.4301 AISI 304	Varenr. Article no.
48,3	68,3	87,3	85,0	0,90		▶ 15095
54,0	74,0	93,0	85,0	1,00		▶ 25501
60,3	80,3	99,3	85,0	1,00		▶ 15096
71,0	91,0	110,0	85,0	1,00		▶ 25502
76,1	96,1	115,1	85,0	1,00		▶ 15097
84,0	104,0	123,0	85,0	1,30		▶ 25503
88,9	108,9	127,9	85,0	1,30		▶ 15098
104,0	124,0	143,0	85,0	1,60		▶ 25504
114,3	134,3	153,3	85,0	1,60		▶ 15099
129,0	149,0	168,0	85,0	1,60		▶ 25505
139,7	159,7	178,7	85,0	1,60		▶ 15100
154,0	176,0	198,0	110,0	2,40		▶ 25506
168,3	190,3	212,3	110,0	2,40		▶ 15101
204,0	226,0	248,0	110,0	3,00		▶ 25507
219,1	241,1	263,1	110,0	3,00		▶ 15102
254,0	276,0	298,0	110,0	3,40		▶ 25508
306,0	328,0	350,0	110,0	3,80		▶ 25509
356,0	384,0	414,0	140,0	7,10		▶ 25510
406,0	434,0	464,0	140,0	8,00		▶ 25511

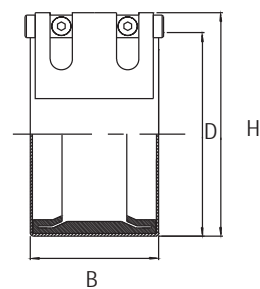

Rørkobling N200

Rørkobling, NT 10, type IV, EPDM pakning, TEEKAY AXIFLEX

Pipe coupling, NT 10, Type IV, EPDM seal, TEEKAY AXIFLEX

Dim	D mm	H mm	B mm	Kg/ stk/pc	EN 1.4404 AISI 316 Varenr. Article no.
48,3	68,3	87,3	85,0	0,90	▶ 15087
54,0	74,0	93,0	85,0	1,00	▶ 15061
60,3	80,3	99,3	85,0	1,00	▶ 15088
71,0	91,0	110,0	85,0	1,00	▶ 15062
76,1	96,1	115,1	85,0	1,00	▶ 15089
84,0	104,0	123,0	85,0	1,30	▶ 15063
88,9	108,9	127,9	85,0	1,30	▶ 15090
104,0	124,0	143,0	85,0	1,60	▶ 15064
114,3	134,3	153,3	85,0	1,60	▶ 15091
129,0	149,0	168,0	85,0	1,60	▶ 15065
139,7	159,7	178,7	85,0	1,60	▶ 15092
154,0	176,0	198,0	110,0	2,40	▶ 15066
168,3	190,3	212,3	110,0	2,40	▶ 15093
204,0	226,0	248,0	110,0	3,00	▶ 15067
219,1	241,1	263,1	110,0	3,00	▶ 15094
254,0	276,0	298,0	110,0	3,40	▶ 15068
306,0	328,0	350,0	110,0	3,80	▶ 15069
356,0	384,0	414,0	140,0	7,10	▶ 15070
406,0	434,0	464,0	140,0	8,00	▶ 15071

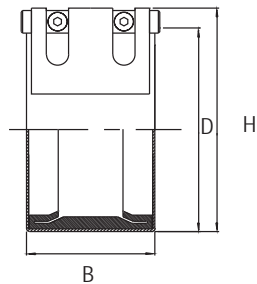

Rørkobling N205

Rørkobling, trækfast, NT 16, type II, EPDM pakning, TEEKAY AXILOCK

Pipe coupling, NT 16, Type II, EPDM seal, TEEKAY AXILOCK

Dim	D mm	H mm	B mm	Kg/ stk/pc	EN 1.4301 AISI 304
					Varenr. Article no.
48,3	71,0	85,0	87,0	1,00	▶ 15079
54,0	77,0	91,0	87,0	1,00	▶ 15072
60,3	83,0	97,0	87,0	1,00	▶ 15080
71,0	95,0	113,0	87,0	1,00	▶ 15073
76,1	100,0	118,0	88,0	1,00	▶ 15081
84,0	108,0	126,0	88,0	1,30	▶ 15074
88,9	113,0	131,0	88,0	1,30	▶ 15082
104,0	128,0	149,0	114,0	1,60	▶ 15075
114,3	138,0	159,0	114,0	1,60	▶ 15083
129,0	153,0	174,0	114,0	1,60	▶ 15076
139,7	166,0	193,0	115,0	1,60	▶ 15084
154,0	181,0	209,0	117,0	2,40	▶ 15077
168,3	195,0	223,0	117,0	2,40	▶ 15085
204,0	232,0	262,0	120,0	3,00	▶ 15078
219,1	247,0	277,0	120,0	3,00	▶ 15086

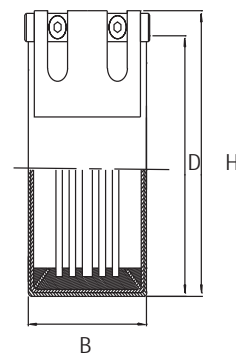

Rørkobling N205

Rørkobling, trækfast, NT 16, type IV, EPDM pakning, TEEKAY AXILOCK
 Pipe coupling, NT 16, Type IV, EPDM seal, TEEKAY AXILOCK

Dim	D mm	H mm	B mm	Kg/ stk/pc	EN 1.4404 AISI 316 Varenr. Article no.
48,3	71,0	85,0	87,0	1,00	▶ 25519
54,0	77,0	91,0	87,0	1,30	▶ 25512
60,3	83,0	97,0	87,0	1,30	▶ 25520
71,0	95,0	113,0	87,0	1,40	▶ 25513
76,1	100,0	118,0	88,0	1,40	▶ 25521
84,0	108,0	126,0	88,0	1,75	▶ 25514
88,9	113,0	131,0	88,0	1,75	▶ 25522
104,0	128,0	149,0	114,0	2,50	▶ 25515
114,3	138,0	159,0	114,0	2,50	▶ 25523
129,0	153,0	174,0	114,0	4,20	▶ 25516
139,7	166,0	193,0	115,0	4,20	▶ 25524
154,0	181,0	209,0	117,0	4,60	▶ 25517
168,3	195,0	223,0	117,0	4,60	▶ 25525
204,0	232,0	262,0	120,0	6,90	▶ 25518
219,1	247,0	277,0	120,0	6,90	▶ 25526

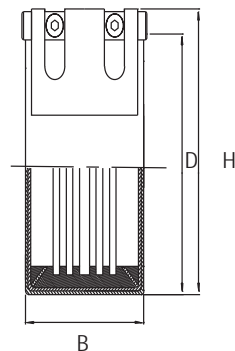

Reparationskobling N210

Reparationskobling, NT 10, type IV, EPDM pakning, TEEKAY REPAIR

Repair pipe coupling, NT 10, type IV, EPDM seal, TEEKAY REPAIR

Dim	D mm	H mm	B mm	Kg/ stk/pc	EN 1.4404 AISI 316 Varenr. Article no.
84,0	106,0	150,0	110,0	3,00	▶ 25600
104,0	126,0	170,0	110,0	3,20	▶ 25601
129,0	151,0	195,0	110,0	3,20	▶ 25602
154,0	176,0	220,0	110,0	3,60	▶ 25603
204,0	226,0	270,0	110,0	4,20	▶ 25604
254,0	276,0	320,0	110,0	4,60	▶ 25605

